



**HERNANDO
SCHOOL DISTRICT**

Learn it. Love it. Live it.

RFQ # 9009-2601-1001

Powell Middle School HVAC Replacement Project

February 17, 2026



IT WILL BE
RIGHT



IT WILL BE
ON-TIME



IT WILL BE
DELIVERED WITH
**INCREDIBLE
SERVICE**



HVAC Replacement Experts!



Shields Middle School Renovation

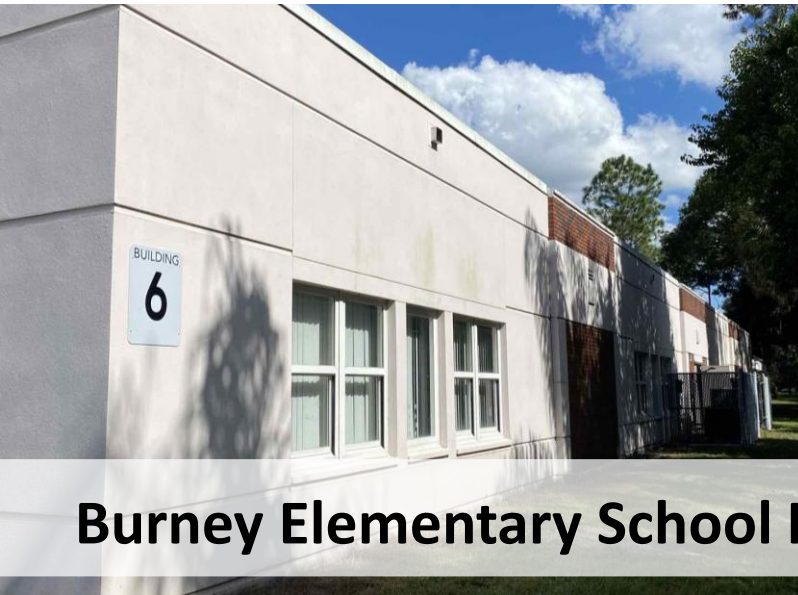

Burney Elementary School HVAC Replacement





HVAC Replacement Experts!



Sickles High School



Pierce Middle School



A background image of a construction site. In the foreground, a worker in a white hard hat and red shirt is working on a concrete wall. In the background, another worker in an orange shirt and white hard hat is visible. Scaffolding and construction materials are scattered throughout the scene.

1. Firm's Resume

Demonstrated capabilities of the applicant, with consideration also given to organizational structure, credentials of senior/professional staff and experience of the organization/staff.



Firm's Resume

The applicant's organizational structure, management methods, distinguishing characteristics, financial condition, etc., should be indicated.

Organizational Structure



Dirk Heller
VP of Operations



ON-SITE CONSTRUCTION TEAM

Margaret Dewar
Project Manager

Scott Richardson
Superintendent

Alex Spano
Asst. Project Manager

EXECUTIVE SUPPORT

Brad Kubin
Chief Operations Officer

PRECONSTRUCTION

Tony Rouse
Chief Estimator

Anthony Rodriguez
Preconstruction Manager

ON-SITE SUPPORT

Hector Cuevas
General Superintendent

Rachel Rosato
Safety Specialist

Firm's Resume

The applicant's organizational structure, management methods, distinguishing characteristics, financial condition, etc., should be indicated.

Management Methods

- Design Review at the Early Stages
- 24/7 Communication
- Project Website

One Point of Contact
Margaret Dewar

Margaret will have all key players on speed dial!



Firm's Resume

The applicant's organizational structure, management methods, distinguishing characteristics, financial condition, etc., should be indicated.

Distinguishing Characteristics



OUR TEAM
sets us apart from the competition

- Executive Oversight
- **50+ HVAC Projects**
- Lessons Learned
- 100% Employee-Owned
- Highly Successful K-12 Experience
- Trusted Partner from Beginning to End
- **WE TAKE OWNERSHIP**

Firm's Resume

Financial Condition

The applicant's organizational structure, management methods, distinguishing characteristics, financial condition, etc., should be indicated.



BONDING CAPACITY
\$200M Single | \$600M Aggregate
WE ARE FINANCIALLY STRONG!



Our K-12 Experience Aligns with Powell Middle School HVAC Replacement Project



- ✓ Working on an Existing Campus
 - ✓ HVAC Replacements
- ✓ Phased Construction Experience

- ✓ Hernando School District Experience
 - ✓ Same Project Team as Eastside ES
 - ✓ Residential Neighborhood

Firm's Resume

Are the proposed staff adequately qualified and will presented team actually be assigned to this project?



Margaret Dewar

Project Manager

7 K-12 projects



Eastside Elementary School Classroom Addition



Shields Middle School Renovation



Gulf High School Replacement



West Zephyrhills Elementary School Replacement



Pierce Middle School Renovation

Firm's Resume

Are the proposed staff adequately qualified and will presented team actually be assigned to this project?



Scott Richardson

Superintendent

7+ K-12 projects



Eastside Elementary School Classroom Addition



Shields Middle School Renovation



Walker Grove Elementary School



John Leigh Elementary School

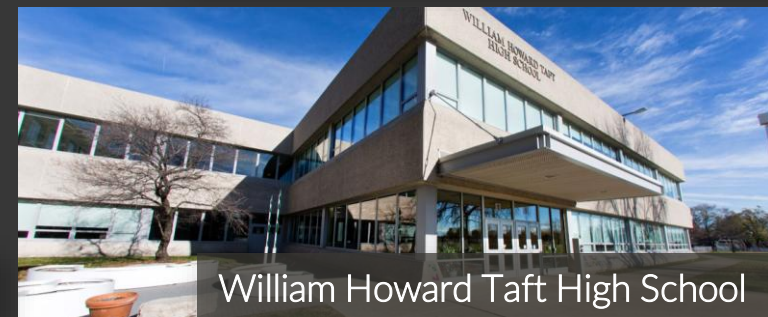

William Howard Taft High School

Margaret Dewar
Project Manager



Scott Richardson
Superintendent

What Qualities = a Great Team?

- Experience working on an Occupied Campus
- Existing Conditions and Utility Coordination
- Strong Phasing Coordination and Sequence
- Daily Communication with On-site Staff
- Quality Control

Presented team will be assigned to this project!

Firm's Resume

Are the proposed staff adequately qualified and will presented team actually be assigned to this project?



Pasco County School Project	Proposed Team	Actual Team
Eastside Elementary School	Dirk Heller, Tony Rouse, Mike Johnson, Margaret Dewar, Scott Richardson	Dirk Heller, Tony Rouse, Mike Johnson, Margaret Dewar, Scott Richardson
Sunlake High School Classroom Addition	Dirk Heller, Tony Rouse, Luke Johnson, Mark Stohs	Dirk Heller, Tony Rouse, Luke Johnson, Mark Stohs
Gulf High School Replacement	Dirk Heller, Tony Rouse, Nick Mercurio, John Barber	Dirk Heller, Tony Rouse, Nick Mercurio, John Barber
Starkey Ranch K-8 Classroom Addition	Dirk Heller, Tony Rouse, Mark Stohs, Will Sievers	Dirk Heller, Tony Rouse, Mark Stohs, Will Sievers
West Zephyrhills Elementary School Replacement	Dirk Heller, Tony Rouse, Nick Mercurio, John Barber	Dirk Heller, Tony Rouse, Nick Mercurio, John Barber
Pasco High School Building Addition	Dirk Heller, Tony Rouse, Garrett Early, Mark Stohs	Dirk Heller, Tony Rouse, Garrett Early, Mark Stohs
Pasco High School Stadium Replacement	Dirk Heller, Tony Rouse, Garrett Early, Mark Stohs	Dirk Heller, Tony Rouse, Garrett Early, John Barber

2. Firm's Current Workload & Capacity

An evaluation of the applicant's capacity to undertake additional work, in light of its current workload.



Firm's Current Workload & Capacity

The presentation/interview should indicate the applicant's historical workload, the current workload, and the workload projected during the time period of the contract.

Historical Workload

Williams Company Historical, Current, & Projected Workload

Workload (in millions): 2020 - 2026

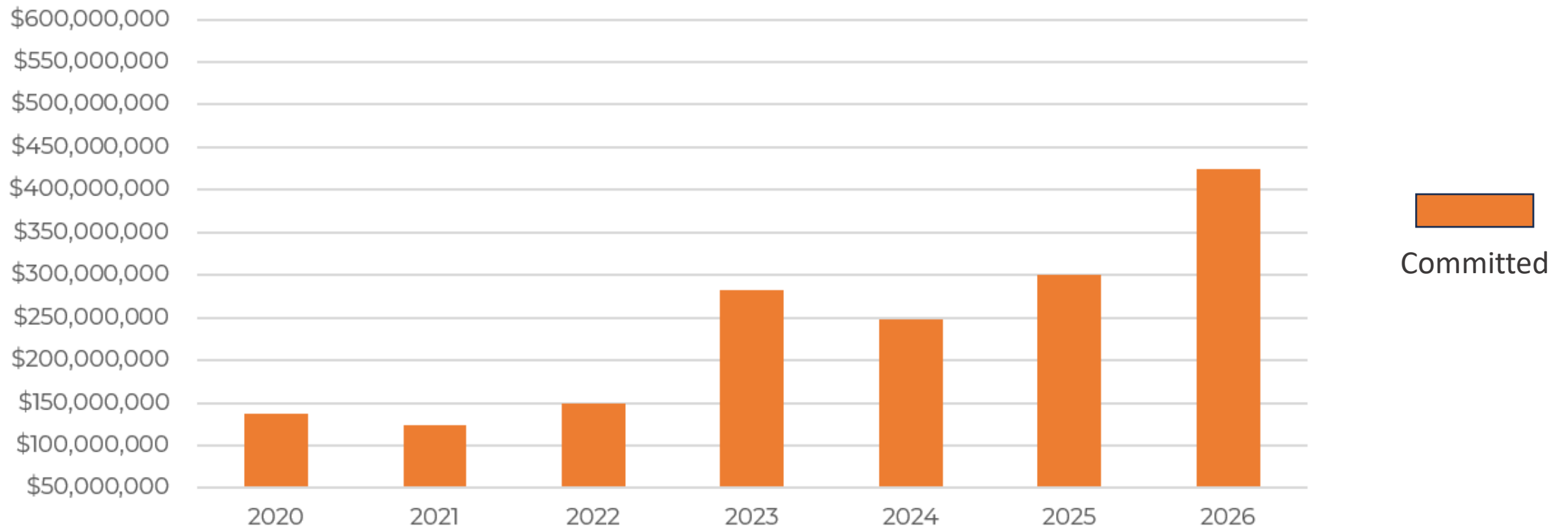

Firm's Current Workload & Capacity

The presentation/interview should indicate the applicant's historical workload, the current workload, and the workload projected during the time period of the contract.

Current Workload





Margaret & Scott will be available during preconstruction and construction.

Outstanding Project	Client Name	Status	Anticipated Completion Date	Original Contract Amount
Eastside Elementary School Classroom and Cafeteria Addition	Hernando County School District	41%	09/2026	\$21,273,321
Two Rivers K-8 School	Pasco County School Board	Precon	05/2028	\$82,000,000
Kirkland Ranch K-8 Addition	Pasco County School Board	Precon	05/2028	\$23,000,000
West Zephyrhills Elementary School	Pasco County School Board	63%	05/2026	\$57,600,000
Pasco High School Addition and Stadium Replacement	Pasco County School Board	67%	09/2026	\$42,125,969
Lakeland Highland Middle School Gymnasium Addition	Polk County Public Schools	41%	07/2026	\$9,700,000
Block F1 Redevelopment	WS Development	17%	09/2026	\$8,500,000

Firm's Current Workload & Capacity

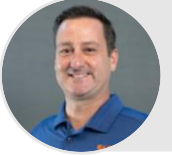
The presentation/interview should indicate the applicant's historical workload, the current workload, and the workload projected during the time period of the contract.

Projected Workload

	Role	% Available	Responsibility
 Margaret Dewar	Project Manager	50% 100%	Preconstruction Construction
 Scott Richardson	Superintendent	20% 100%	Preconstruction Construction
 Alex Spano	Assistant Project Manager	30% 100%	Preconstruction Construction
 Dirk Heller	Vice President of Operations	20% 20%	Preconstruction Construction
 Tony Rouse	Chief Estimator	25% As Needed	Preconstruction Construction
 Anthony Rodriguez	Preconstruction Manager	100% As Needed	Preconstruction Construction

Firm's Current Workload & Capacity

Past or future changes in staffing levels should be indicated.



Williams Company Tampa does not have any changes to the staffing levels planned.

Firm's Current Workload & Capacity

Allocation of duties among staff and subcontractors should be indicated.

- Thorough Prequalification Process
- Sub Backlog Verification
- References
- Personal Phone Calls

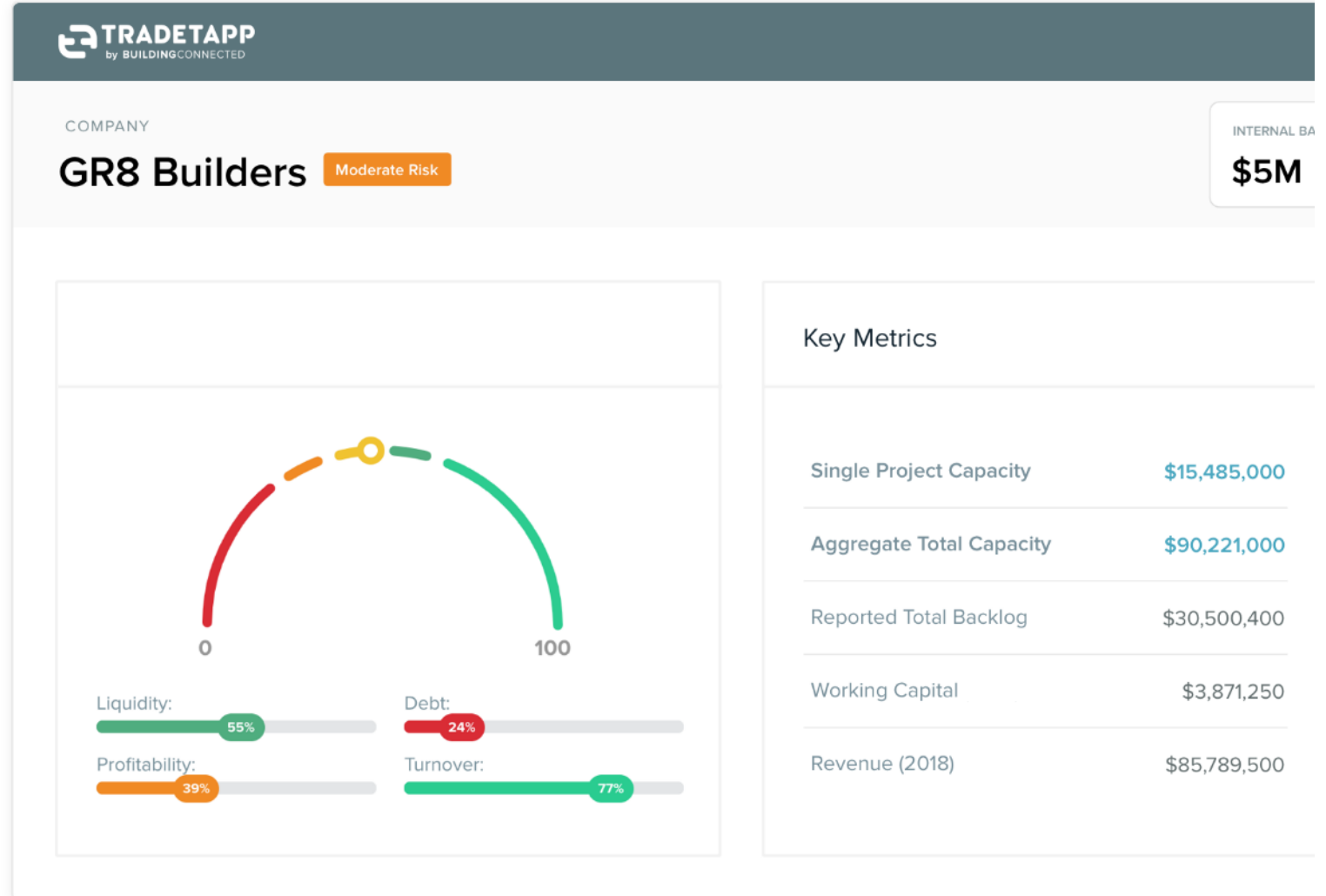

Firm's Current Workload & Capacity

Applicant has current staff available for pre-construction services and will have adequate experienced staff (Superintendent, Project Managers, etc.) to properly manage this project

PRECONSTRUCTION BENCH STRENGTH AND DEPTH OF RESOURCES.

170⁺

Avg. projects per year

\$2.5^B

Estimated in 2025

100^s

Of Happy Clients



3. M/WBE & Local Workforce Participation

Whether the applicant is a certified minority/woman owned business enterprise. Whether the applicant has demonstrated a commitment to increasing the successful participation of certified minority and women owned businesses. Whether the applicant is a local business or employees are residents of Hernando County. Does the applicant encourage the use of Florida and Hernando County construction workforce?



M/WBE & Local Workforce Participation

A clear demonstration of a commitment to diversity by prospective consultants seeking business with the District is expected.



Look at our other Clients MWBE, VBE & LDB Programs to bring in new subs



Outreach, Outreach, Outreach



Work with existing subs to get them certified as M/WBE's



Vet subs with the Hernando School District

M/WBE & Local Workforce Participation

The District seeks to encourage participation by local vendors and Florida based construction workforce.

- AJS Building
- Central Florida Land Service
- Complete Drywall of Hernando, Inc.
- Construction Genes LLC
- Driggers Engineering Services
- Dynasty Land Management
- EC Building Solutions
- Eddy's Excavating
- Faulkner Electric
- Foster's Roofing Enterprises, Inc.
- H2O Plumbing Solutions
- Industrial Welding & Maintenance, Inc.
- JLE Coatings
- Lee Hayes Stucco & Stone

- Meares Plumbing
- Mike Daniel's Construction
- Millennium Commercial Cleaning
- RH Welding
- Right Electrical Contractors
- R&R Garage Doors

- Senica Air Conditioning, Inc.
- Simmons Site Development
- Supreme Coatings
- Swift Construction and Painting
- Unlimited Site Services, Inc.

DATABASE OF OVER 75 HERNANDO COUNTY SUBS

DATABASE OF OVER 600 CENTRAL FLORIDA SUBS

Examples of Local Business Participation

The District seeks to encourage participation by local vendors and Florida based construction workforce.

Shopping & Purchasing Local



Local Dollars: \$100,000+

- Lunches
- Subcontractor appreciation
- BBQ's
- Gas for vehicles
- Hotel stays
- Supply runs

Examples of Local Business Participation

The District seeks to encourage participation by local vendors and Florida based construction workforce.

Island Village Elementary

Sub/Vendor Contract Value: \$17,665,490



Pershing K-8 School

Sub/Vendor Contract Value: \$17,948,366



Lake Como K-8

Sub/Vendor Contract Value: \$18,082,268



Local Percentage:

71%

Local Dollars:

\$12,528,621

Local Percentage:

82%

Local Dollars:

\$14,823,348

Local Percentage:

63%

Local Dollars:

\$11,442,702

M/WBE & Local Workforce Participation

For this project, what is the applicants plan to include and recruit MWBE & Local Workforces



Community Forums



Outreach Events



Personal Phone Calls



Early & Frequent Notifications



Follow-Up



Established Relationships



Subcontractor Prequalification



Site Visits





Eastside Elementary School Topping Out

A photograph of three construction workers on a site. The worker in the center is wearing a grey hard hat and a high-visibility yellow safety vest with the Williams Company logo on the back. To his left, another worker wears a red hard hat and a yellow safety vest. To his right, a third worker wears a grey hard hat and a yellow safety vest. The background shows the steel framework of a building under construction.

4. Construction Management Approach

Applicant's ability and methods to manage the project from pre-construction through contract closeout.



Preconstruction Services

**Our Success comes from our KNOWLEDGEABLE
PRECONSTRUCTION TEAM and STRONG LOCAL RELATIONSHIPS.**

**Estimate
Development
Begins at Program
Verification**

**Cost Estimator
Involved
Throughout
Design**

**Updated Estimate
after every
major scope
modification**

**Effective Cost
Containment**

Construction Management Approach

The presentation should indicate the applicant's ability and methods to perform pre-construction services, budgeting, cost analysis, bidding, contract management, quality control and other tasks related to this project.

Budgeting

Ability to Maintain Budget **SINCE 1920**



Sunlake Classroom Addition
Budget – \$8M
GMP - \$6.9M
Savings - \$1.1M



Parrish Community High School Addition
Budget – \$10.5M
GMP - \$9.3M
Savings - \$1.2M



OCPS - Boone High School
Budget – \$55.6M
GMP - \$51.9M
Savings - \$3.7M

Construction Management Approach

The presentation should indicate the applicant's ability and methods to perform pre-construction services, budgeting, cost analysis, bidding, contract management, quality control and other tasks related to this project.

Bidding

- **Complete and Correct Scope**
- **Clearly Communicate to Subcontractors**
 - Prior to GMP
 - Eliminate Surprises!
 - No Change Orders for Logistics/Phasing/Mobilizations!
- **Complete and Correct Proposals**
 - Subs Understand and Include all Scope



Construction Management Approach

The presentation should indicate the applicant's ability and methods to perform pre-construction services, budgeting, cost analysis, bidding, contract management, quality control and other tasks related to this project.

Bidding

Coverage! Coverage! Coverage! Bid Participation on Eastside Elementary School

Sitework	4
Masonry	5
Structural Steel	4
Fire Protection	5
Plumbing	4
Drywall & Framing	4
Roofing	6
Painting	4
Electrical/Low Voltage	5
Test & Balance	4
Furniture	5



Construction Management Approach

The presentation should indicate the applicant's ability and methods to perform pre-construction services, budgeting, cost analysis, bidding, contract management, quality control and other tasks related to this project.

Contract Management

- PROCORE and DroneDeploy
- Daily and Weekly OAC Meetings
- Monthly Reports
- Site Visits
- Project Photos and Documentation
- Recap Emails



Williams Company Tampa
5201 West Kennedy Blvd., Suite 535
Tampa, Florida 33609
P: (813) 418-3810
F: (813) 418-3819

Project: 23501 PCPS Stephens ES - Interior Remodel
1350 N. Maple Avenue
Bartow, Florida 33830

OAC Meeting Minutes: Meeting #7

Meeting Date: Jul 11, 2023 **Meeting Time:** 1:30 PM - 2:30 PM Eastern Time (US & Canada)

Meeting Location: 1350 N Maple Ave, Bartow, Florida 33830

Overview: Weekly OAC meeting to discuss the schedule and general project related coordination. Meeting will be held on the school campus in Building 5

Notes: Please notify Margaret Dewar regarding any discrepancies in the meeting notes requiring correction and redistribution. Meeting notes may be expanded upon post-meeting for further clarity. Meeting notes are assumed to be accurate and accepted if no changes or corrections are communicated within 48 hours of distribution.

Other Attendees not listed:

Attachments: [PCPS_Stephens_ES_Renovations-Change_Event_Log_REV1_2023-07-11.pdf](#), [22-51 Building 2 Final Inspection 07-07-23.pdf](#), [04_Stephens_ES-Site_Logistics.pdf](#), [IMG_0394.JPG](#), [Stephens_ES_Remodel_Sched_2023-07-11.pdf](#), [Stephens - Circulation Desk.PNG](#)

Site Logistics

No.	Mtg Origin	Title	Assignment	Due Date	Priority	Status	Old/New
1.1	1	Overall Review				Open	Old
<p>Description Logistics plan attached, which was handed out at the Kick-Off meeting. General discussion about how this is working and any current issues needing to be addressed, as construction starts and progresses.</p> <p>Official Documented Meeting Minutes</p> <ul style="list-style-type: none"> Logistics plan is working well. No longer having issues routing parents to office. <p>Previous Meeting Minutes Jun 27, 2023</p> <ul style="list-style-type: none"> Outdoor signage is good. 							

Schedule

No.	Mtg Origin	Title	Assignment	Due Date	Priority	Status	Old/New
2.1	1	Construction Schedule				Open	Old
<p>Description Review of the current schedule and progress. Updated schedule attached to the agenda.</p> <p>Building 2:</p> <ul style="list-style-type: none"> Punchlist was created on Friday. 							

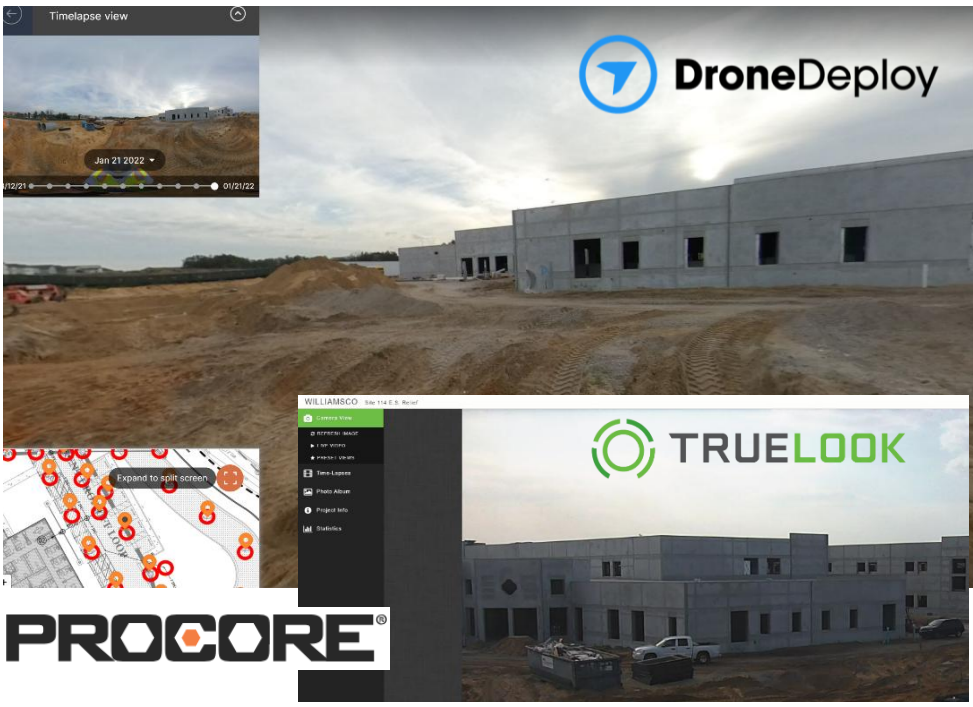

“Williams Company is an excellent CM firm and I highly recommend them for any scale project. They are not just a firm that you will work with again but a firm that you want to work with again.”

- Caton Gantt, Project Coordinator, Pasco County Schools

Construction Management Approach

The presentation should indicate the applicant's ability and methods to perform pre-construction services, budgeting, cost analysis, bidding, contract management, quality control and other tasks related to this project.

QUALITY CONTROL PROCESS

3 STEP PROCESS



Construction Management Approach

The presentation should indicate the applicant's ability and methods to perform pre-construction services, budgeting, cost analysis, bidding, contract management, quality control and other tasks related to this project.

QUALITY CONTROL PROCESS

1

PRE- CONSTRUCTION

DESIGN GUIDELINE REVIEW

Verification that the specifications align with the district design guidelines.

SUBSTITUTIONS

NO substitutions after GMP.

SUBCONTRACTOR CAPABILITY

Financial capability and workload capacity.

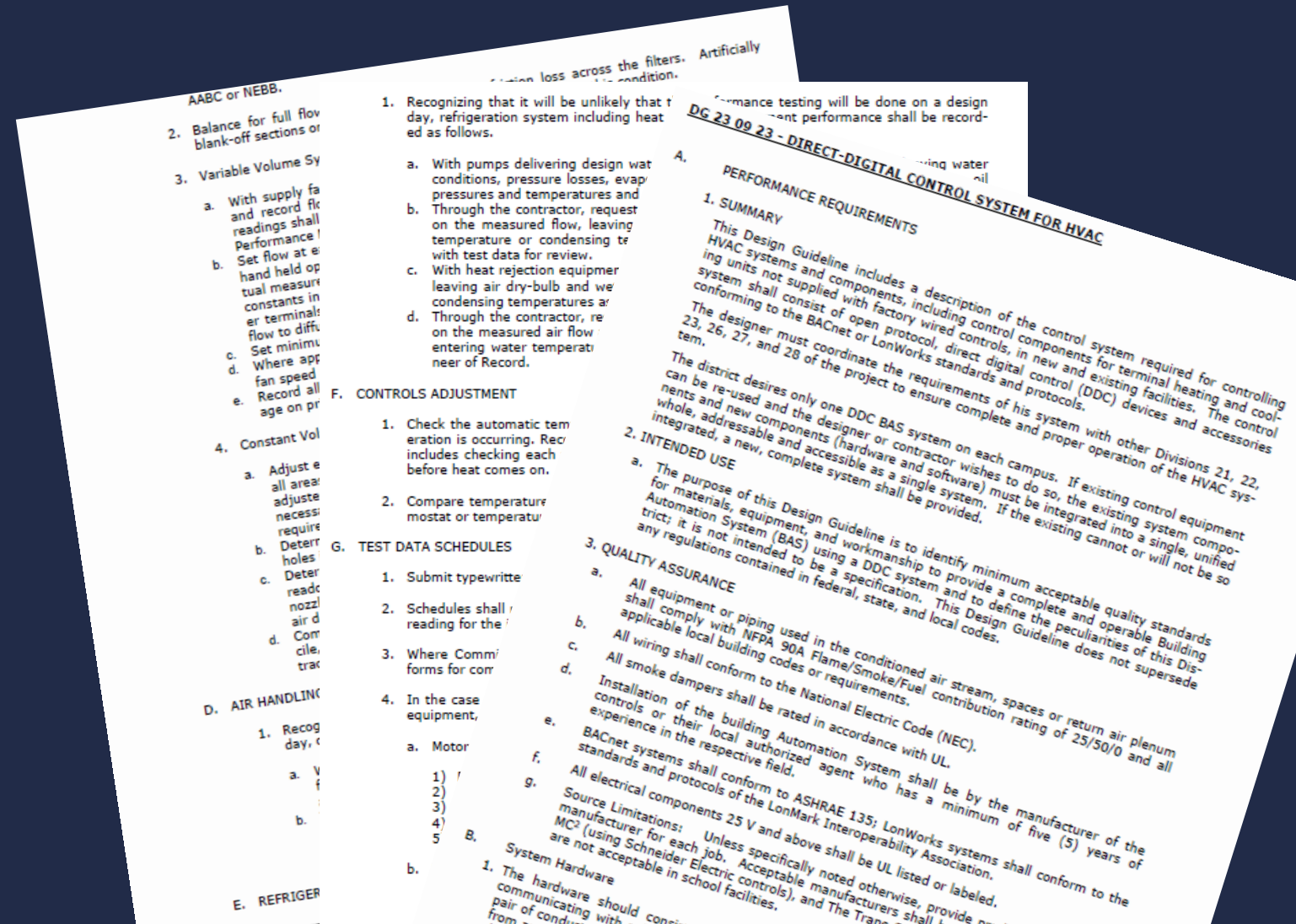

Construction Management Approach

The presentation should indicate the applicant's ability and methods to perform pre-construction services, budgeting, cost analysis, bidding, contract management, quality control and other tasks related to this project.

QUALITY CONTROL PROCESS

2 SUBMITTALS

COLLABORATIVE REVIEWS

Project Team is engaged in the review process.

REVIEW CHECKLISTS

Ensure consistency across reviewers.

COMPLIANCE FOCUS

NO deviation from specifications.
No Exceptions. Period.



Construction Management Approach

The presentation should indicate the applicant's ability and methods to perform pre-construction services, budgeting, cost analysis, bidding, contract management, quality control and other tasks related to this project.

QUALITY CONTROL PROCESS

3

FIELD BASED

PRE-INSTALLATION MEETINGS

Scope and Spec reviews with Subcontractor PM and Foreman on site.

MATERIAL VERIFICATION

Ensure compliance upon delivery, not during installation.

INSTALLATION COMPLIANCE

Mockups when needed and continuous monitoring from the on-site team with daily reporting.



Construction Management Approach

Past or current litigation or liquidated damages claims against the applicant should be listed with consideration given to the applicant's explanation of these circumstances.

**Williams Company Tampa
has had zero litigation or
liquidated damages claims.**



Construction Management Approach

The presentation should indicate the applicants approach to closeout including final payment, Board approval and 3rd party audit participation.

Closeout

- Starts at preconstruction
- Keeping as-built documents up-to-date throughout the project
- Being proactive in gathering all operational and maintenance documents at 50% of occupancy
- We punch list as we go along
- Staff and Maintenance Training

We guarantee to close out your project in 30 days or less from Substantial Completion.

08/02/2023

Printed on Fri May 17, 2024 at 03:40 pm EDT
Job #: 23501 PCPS Stephens ES - Interior Remodel
1350 N. Maple Avenue
Bartow Florida. 33830

WILLIAMS COMPANY
Williams Company Tampa
5201 West Kennedy Blvd., Suite 535
Tampa, Florida 33609
United States
(813) 418-3810

Punch Items for 23501 - PCPS Stephens ES - Interior Remodel 246 Items

#253: Drywall Patch/Repair

Type:	Location: Building 1>01-041B Storage	
Date Created: 08/02/2023	Due Date: 08/06/2023	
Priority:	Status: Closed by Margaret Dewar on 08/04/2023	
Creator: Michael Johnson	Reference:	
Punch Item Manager: Margaret Dewar	Final Approver: Margaret Dewar	
Ball in Court:	Assignee Name: Jewell, Steven (MB Drywall Solutions, LLC) <i>Work Required</i>	

Description:

#251: Ceramic/Hard Tile Damage

Type:	Location: Building 1>01-046C Girl's Toilet	
Date Created: 08/02/2023	Due Date: 08/06/2023	
Priority:	Status: Closed by Margaret Dewar on 08/04/2023	
Creator: Michael Johnson	Reference:	
Punch Item Manager: Margaret Dewar	Final Approver: Margaret Dewar	
Ball in Court:	Assignee Name:	

Description:



5. Featured Projects and Project Approach

Applicant and staff's prior performance on educational facilities projects, including ability to meet project schedule and budget. Consideration will be given to more recent projects and projects of similar dollar volume and scope in establishing the applicant's record of successfully completing continuing service projects.



Featured Projects & Project Approach

The presentation should establish the applicant's record of successfully completing projects of similar scope and complexity. Experience with public educational or technical facilities should be indicated.



200+
K-12 SCHOOLS



55+
YEARS OF BUILDING
K-12 SCHOOLS



\$1+
BILLION
IN K-12
PROJECTS



12
SCHOOL DISTRICTS



105+
YEARS IN
CENTRAL FLORIDA



7
MILLION
SQUARE FEET
K-12 PROJECTS



K-12
COMPREHENSIVE
RENOVATIONS &
HVAC
REPLACEMENTS



Featured Projects & Project Approach

The presentation should establish the applicant's record of successfully completing projects of similar scope and complexity. Experience with public educational or technical facilities should be indicated.

HVAC Replacements – Occupied Campus



Shields Middle School Renovation

Challenges of the Project

- Site Safety - Working on An Occupied Campus
- Phasing and Sequencing of Renovations
- Early Procurement



Featured Projects & Project Approach

The presentation should address the applicant's intended approach to anticipated challenges or unique characteristics of this proposed project. Items such as scheduling, staging, procurement, staffing, phasing, etc. as applicable.

Safety Culture



- Site-specific safety plan and program
- Safety orientation and certification for all members on site

- **Mandatory monthly safety training**
- Daily emphasis on job site supervision
- JLA Badging
- OSHA 30 certified
- **COMMUNICATION**



- Frequent random unannounced visits
- Monitor constantly







Safety – Site Logistics



Powell Site Logistics

Description

-  Contractor Entry Gate
-  Contractor Laydown & Trailer
-  Contractor Site Fencing
-  Modular Classroom Complex
-  Temporary Playfield

Project Approach

DECEMBER 2026 - SITE MOBILIZATION & MODULAR CLASSROOMS

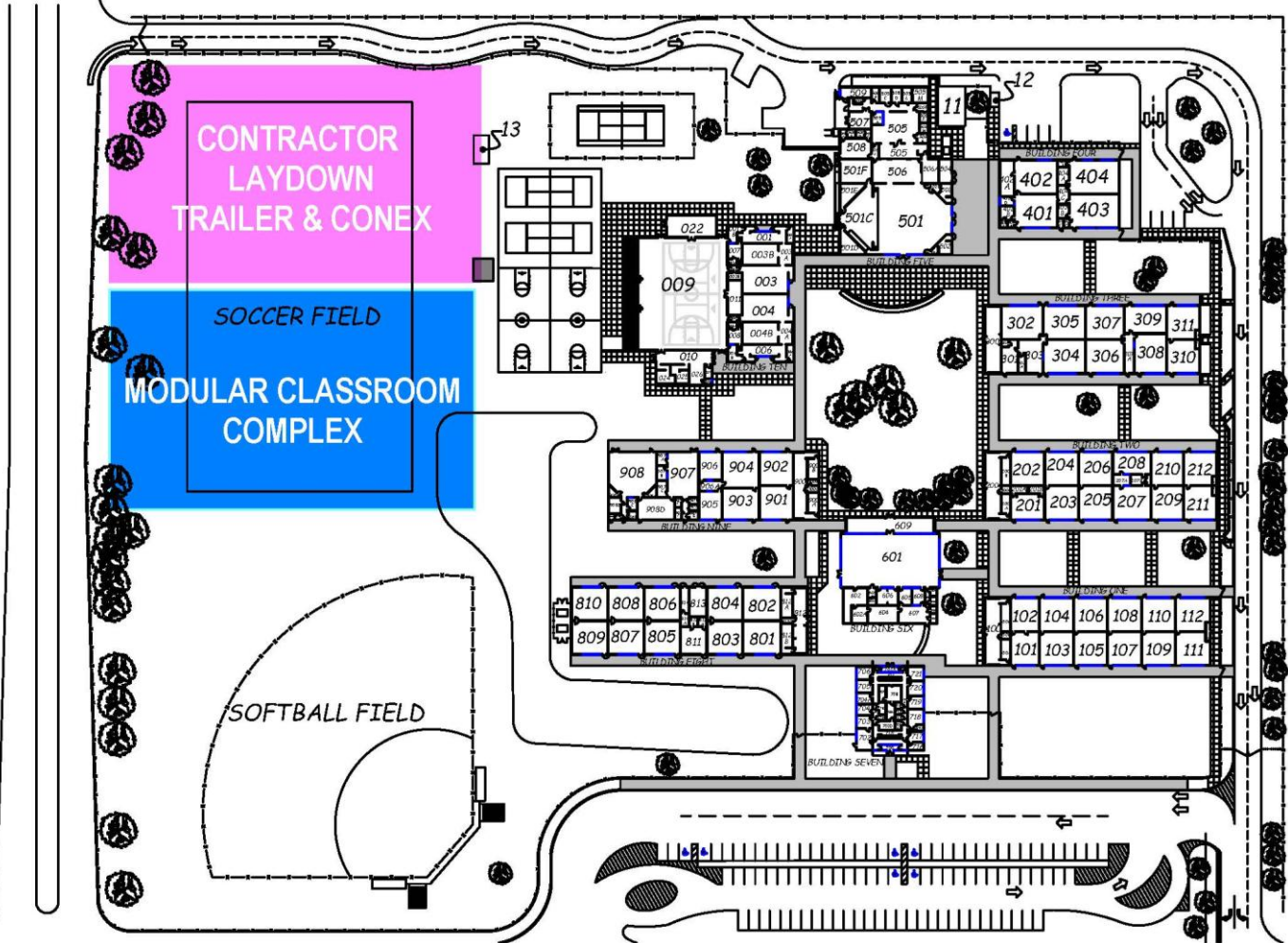

Mobilization & Portables

Dec 2026 – Jan 2027		Feb	Mar	April	May	June	July	Aug	Sept	Oct	Nov	Dec
---------------------	--	-----	-----	-------	-----	------	------	-----	------	-----	-----	-----

Project Approach

JANUARY - FEBRUARY 2027 - CLASSROOM A

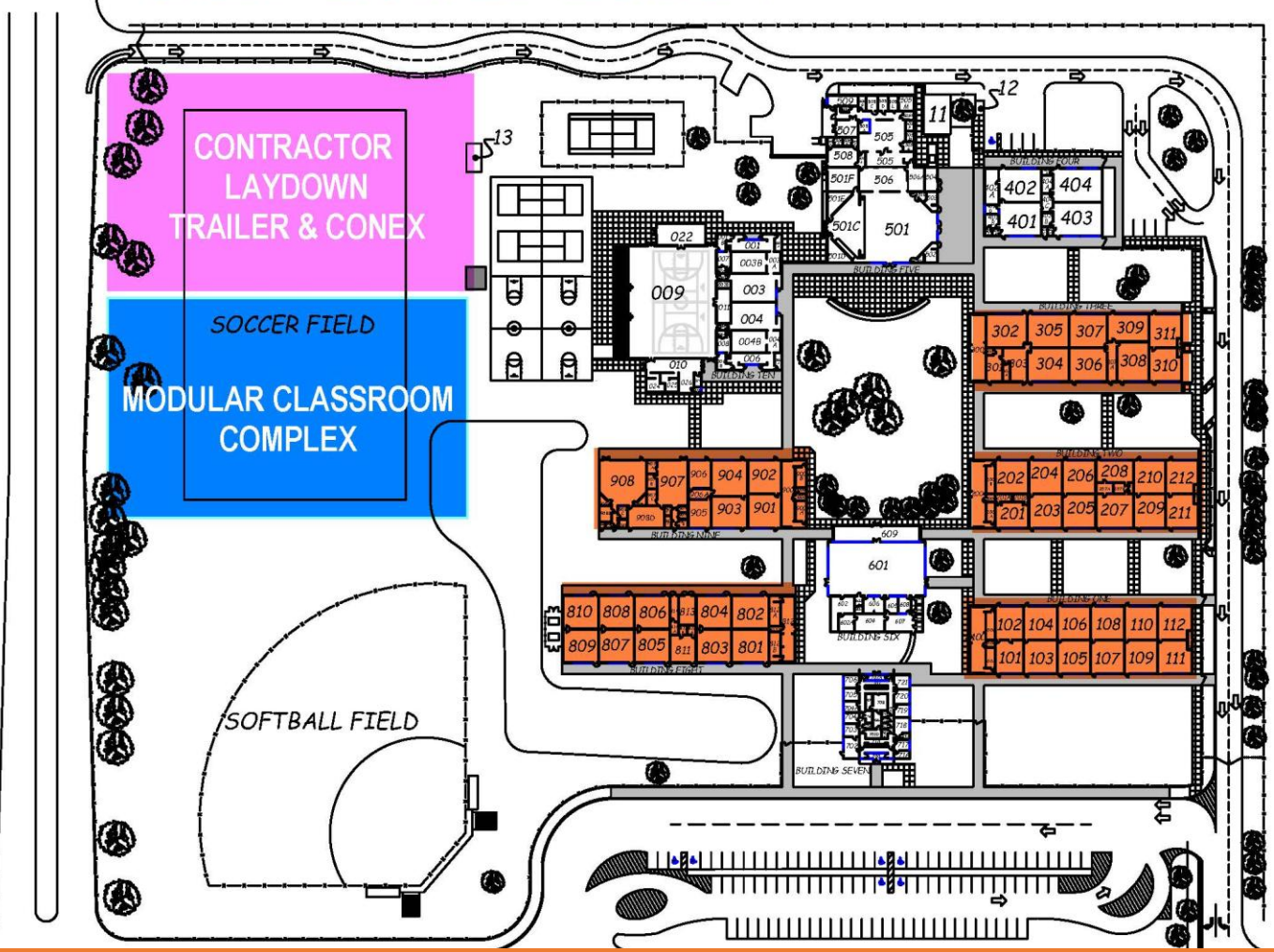

Classroom A

Jan - Feb
2027

Project Approach

MARCH - APRIL - MAY 2027 - CLASSROOM B

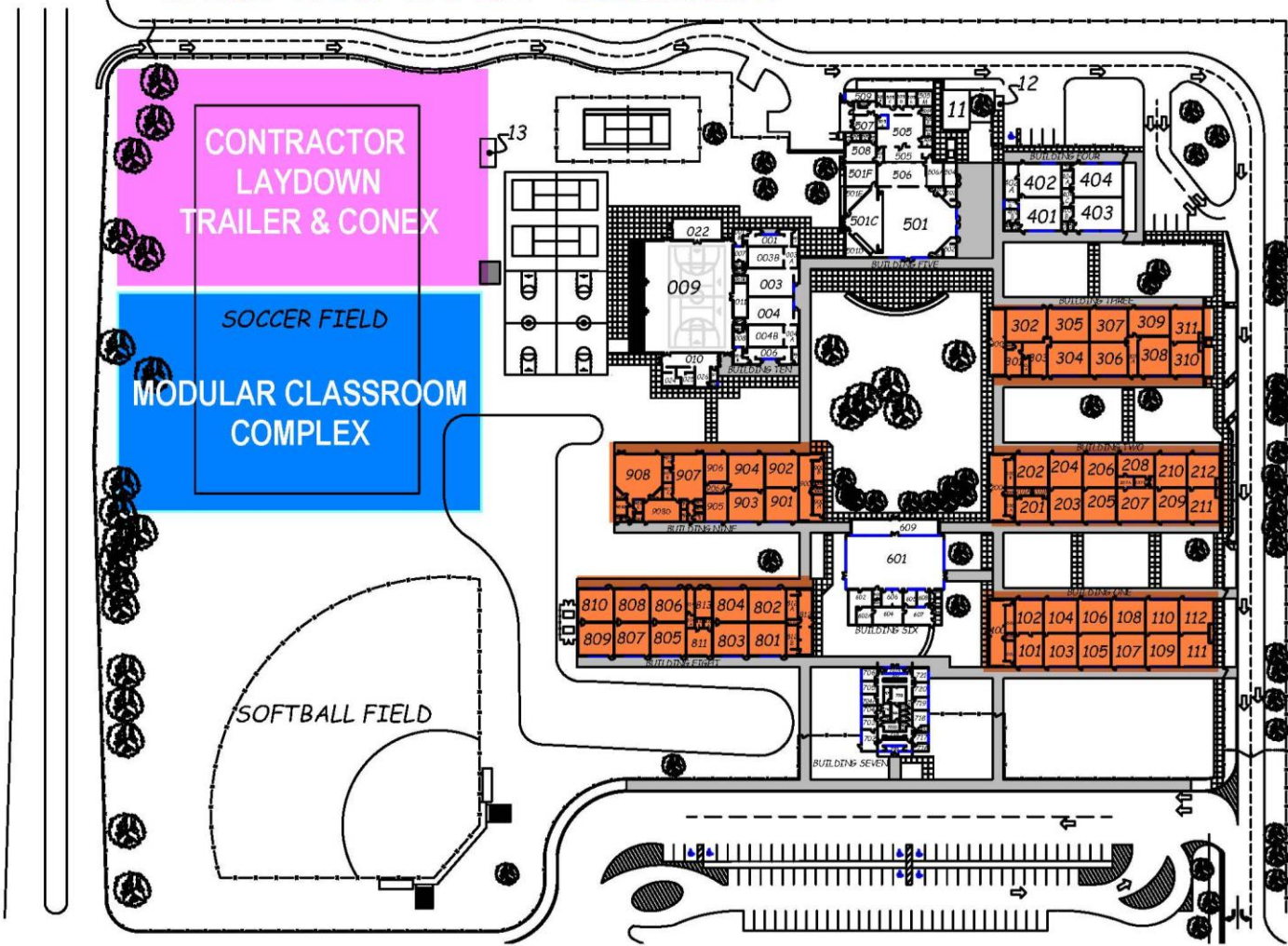

Classroom B

Mar – May 2027

Project Approach

MAY - JULY 2027 - CLASSROOM C & SUPPORT BUILDINGS

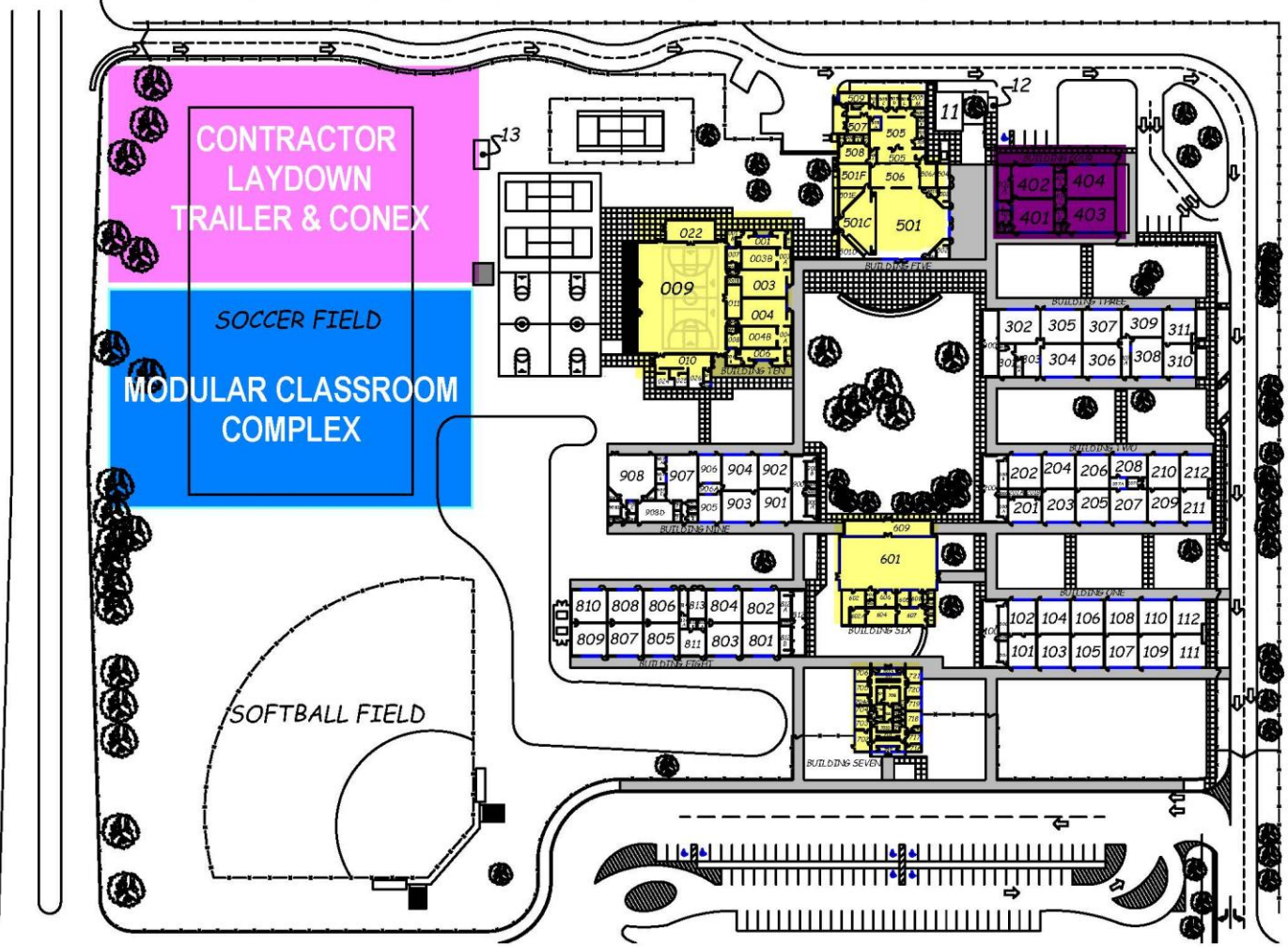

Classroom C & Support Buildings

May – July 2027

Project Approach

AUGUST - SEPTEMBER 2027 - CLASSROOM D

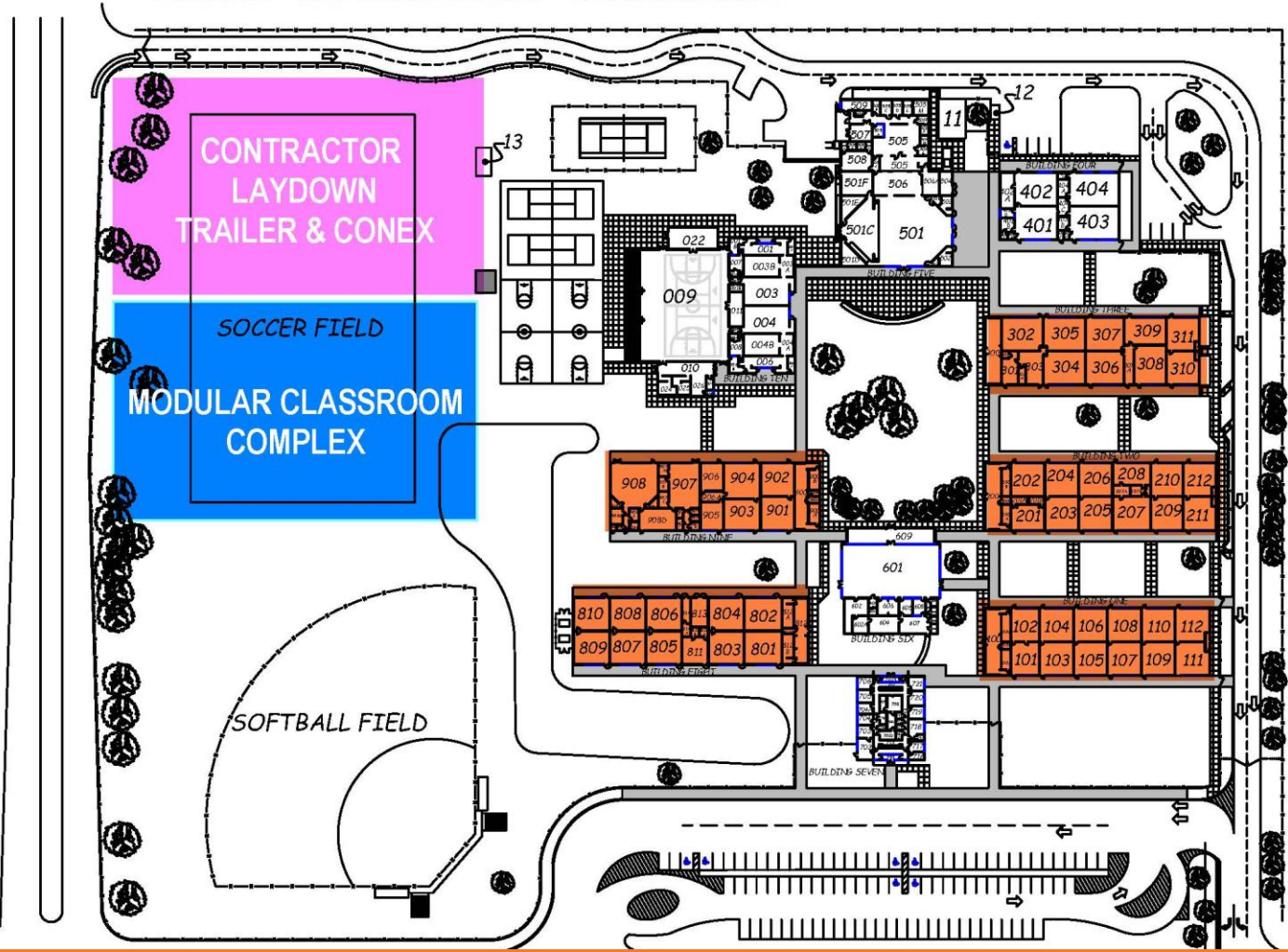

Classroom D

Dec	Jan	Feb	Mar	April	May	June	July	Aug - Sept 2027	Oct	Nov	Dec
								Aug Sept			

Project Approach

OCTOBER - NOVEMBER 2027 - CLASSROOM E

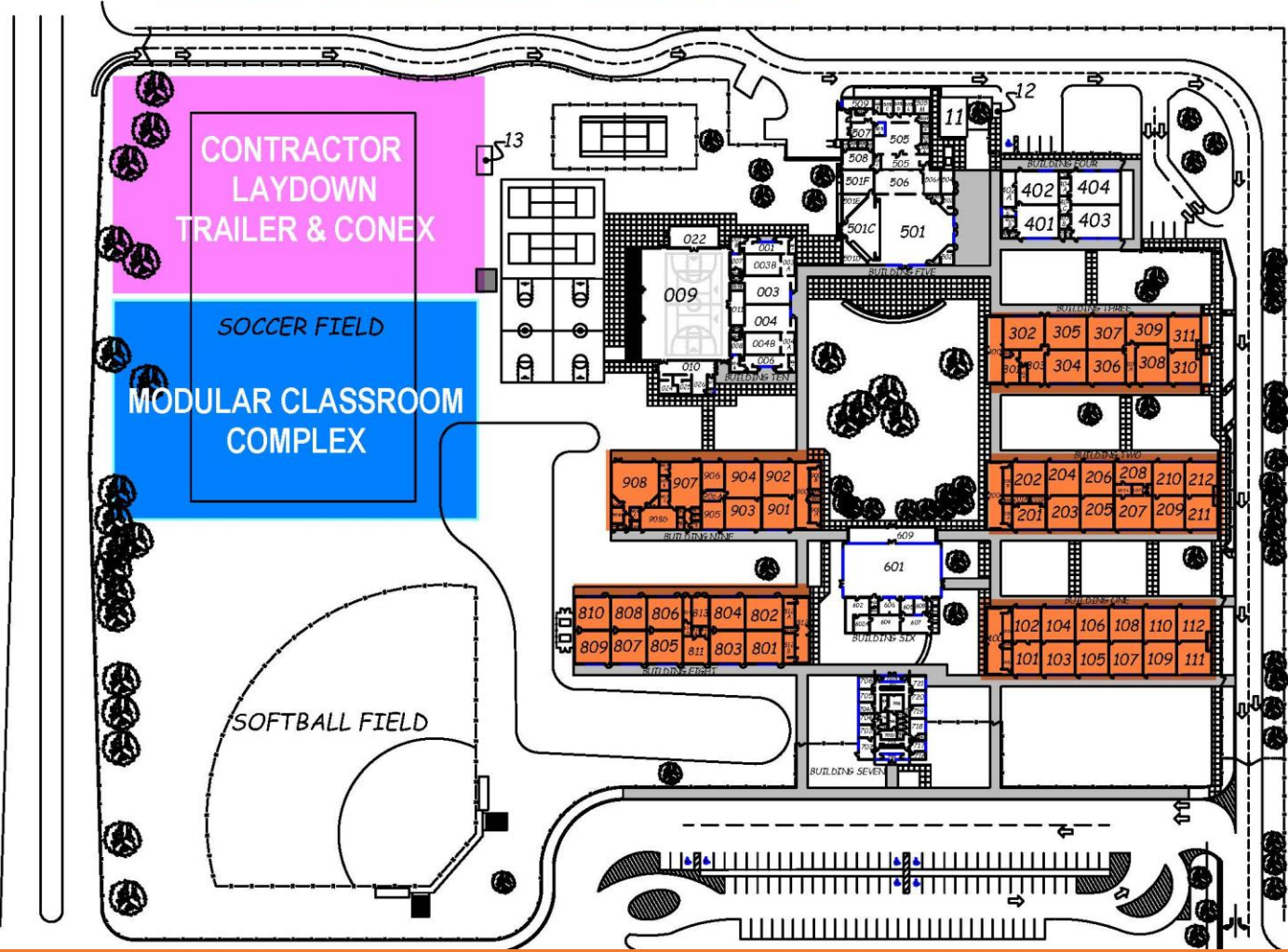

Classroom E

Dec	Jan	Feb	Mar	April	May	June	July	Aug	Sept	Oct - Nov 2027	Dec	
										Oct	Nov	

Project Approach

DECEMBER 2027 - DEMOBILIZATION & SITE RESTORATION

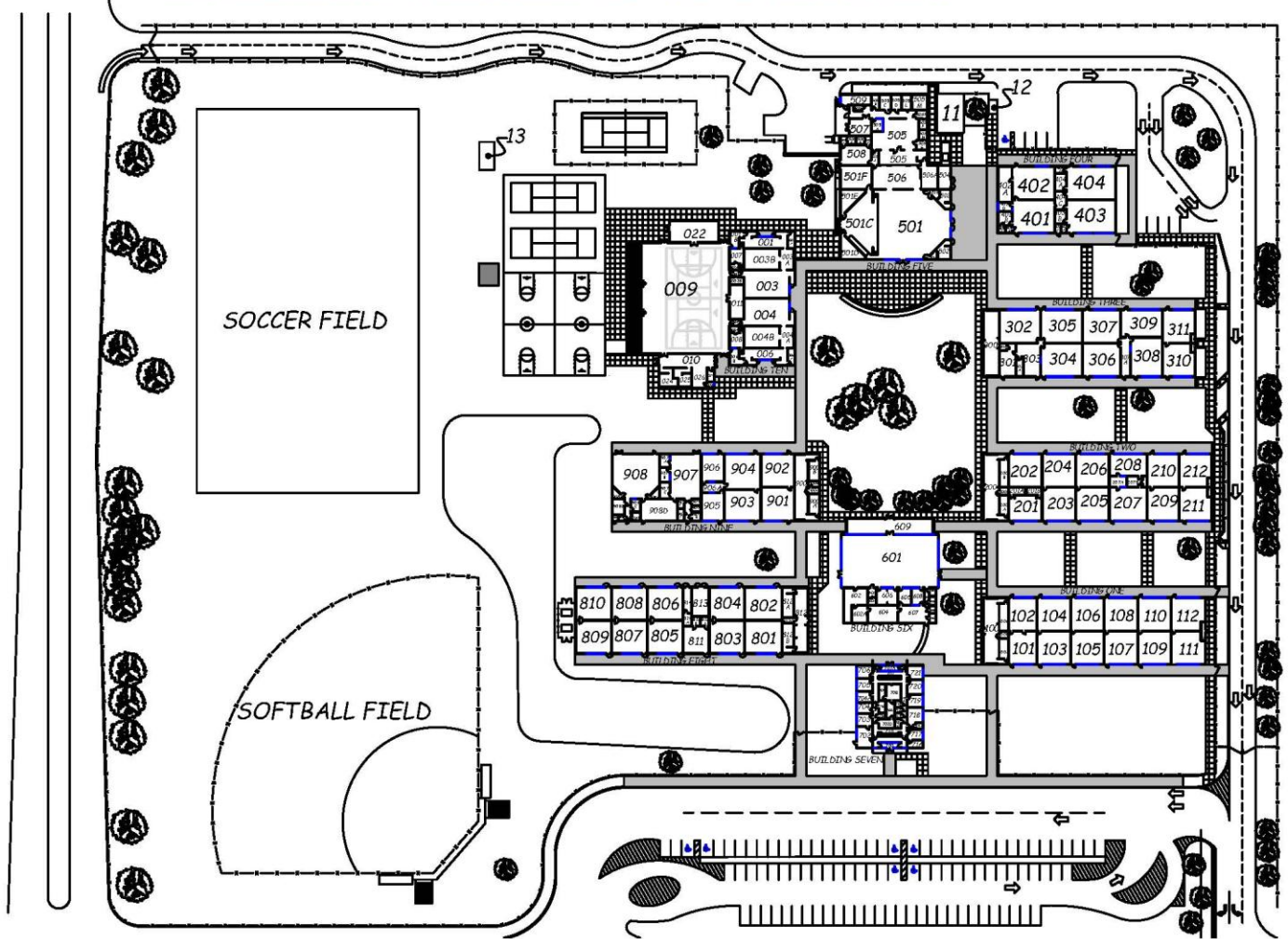

Demobilization

Dec | Jan | Feb | Mar | April | May | June | July | Aug | Sept | Oct | Nov | **Dec 2027** | Dec

Chilled Water Addition

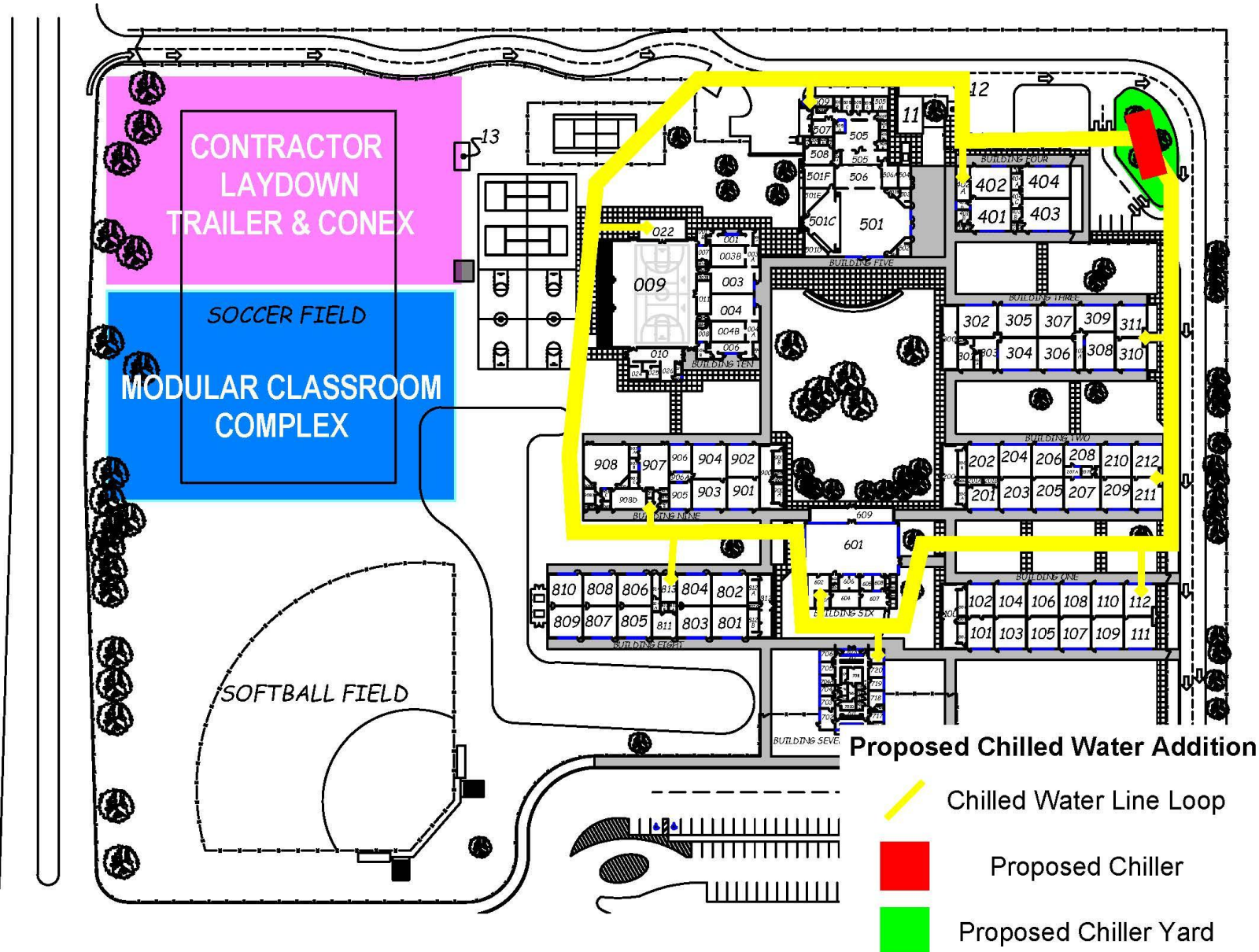

Proposed Chilled Water Addition

- Chilled Water Line Loop
- Proposed Chiller
- Proposed Chiller Yard

Featured Projects & Project Approach

The presentation should address the applicant's intended approach to anticipated challenges or unique characteristics of this proposed project. Items such as scheduling, staging, procurement, staffing, phasing, etc. as applicable.



STEP ONE

Quarterly Walk through with key trades such as Mechanical, Electrical, coatings, joint sealants, and Door Hardware.

SCHEDULE



STEP TWO

Verification of Systems and building components to ensure design intent is maintained.

VERIFY



STEP THREE

Assemble comprehensive report noting deficiencies. Plan location, photos, responsibility, and description included.

REPORT



STEP FOUR

Complete and verify deficiencies noted in the report.
NO COST TO HERNANDO COUNTY SCHOOLS!

COMPLETE

No cost to you!

“ The Williams Company is the best contractor I have worked with during my time at Pasco County Schools. From pre-construction through the warranty phase, a high level of professionalism and responsiveness is consistently delivered.”

- **Caton Gantt, Project Coordinator**
District School Board of Pasco County



PROJECT SURVEY

Project Name: Starkey Ranch K8 Classroom Addition
Client: District School Board of Pasco County
Contact: Caton Gantt, Project Coordinator

Please rate the first three (3) questions on a scale of 1-10
(1= Poor, 5 = Average, 10 = Excellent)

- 1) How was the overall performance of the Williams Company on your project? 10
- 2) How well did our Project Manager perform on the project? 10
- 3) How well did our Superintendent perform on the project? 10
- 4) What are we doing right?
The Williams Company team is the best contractor I have worked with during my time at Pasco County Schools. From pre-con through the warranty phase, a high level of professionalism and responsiveness is consistently delivered. Keep up the good work!
- 5) What could we be doing better?
I have no complaints at this time.
- 6) Would you recommend Williams Company for future projects?
(Please circle one)

Would not recommend **Would recommend** **Would highly recommend**

Additional Comments:

Signature

4/30/24
Date

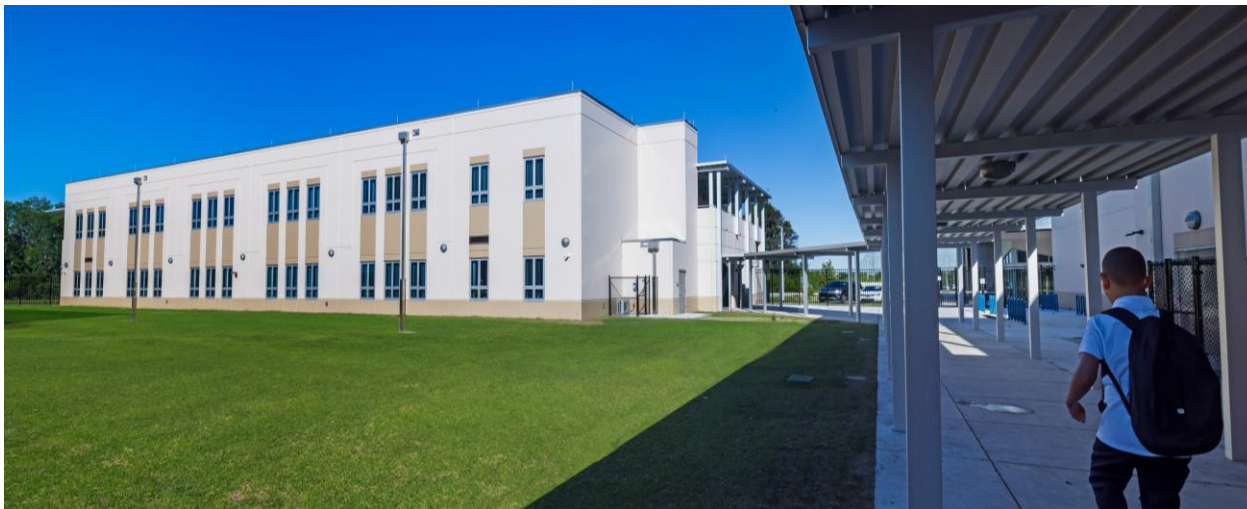



GROWTH

RESPECT

OWNSHIP

WINNING ATTITUDE

LEADERSHIP



*We build **QUALITY SCHOOLS**
so you can provide
our children with a
QUALITY EDUCATION.*





WHY WILLIAMS COMPANY

- **Hernando County Trade Partners**
 - **Proven and Trusted Partner**
 - **100% Employee-Owned**
 - **Occupied Campus Experts**
- **We have the BEST LOCAL TEAM!**



It Will Be
Right



It Will Be
On-Time



It Will Be
Delivered With
**Incredible
Service**

Construction Management Approach

The presentation should indicate the applicant's ability and methods to perform pre-construction services, budgeting, cost analysis, bidding, contract management, quality control and other tasks related to this project.

HVAC Replacement Projects

Year	Project	Student Stations	SQFT	GMP Amount	\$/SQFT	\$/Student
2019	Sickles HS	2,471	321,539	\$18,316,450	\$56.96	\$7,412.57
2021	Burney MS	394	49,594	\$2,617,985	\$52.79	\$6,644.63
2022	Pierce MS	1,339	120,000	\$6,184,545	\$51.54	\$4,618.78
2023	Shields MS	1,746	129,215	\$6,328,817	\$48.98	\$3,624.75
2023	Westbrook ES	1,001	93,150	\$4,830,578	\$51.86	\$4,825.75

Year	Project	Student Stations	SQFT	GMP Amount	\$/SQFT	\$/Student
2027	Powell MS	1,061	126,132	\$8,634,997	\$68.46	\$8,138.55
			* Estimated		* Adjusted	

2RK8 HVAC Only - 90% Budget Check \$/SQFT:	\$53.28	\$61.80
KRK8 HVAC Only - DD Budget \$/SQFT:	\$59.02	\$68.46

Featured Projects & Project Approach

The presentation should establish the applicant's record of successfully completing projects of similar scope and complexity. Experience with public educational or technical facilities should be indicated.

HVAC Replacements – Occupied Campus



Sickles High School



Burney Elementary School



Boone High School



Blankner K-8 School



Shields Middle School



Pierce Middle School

Featured Projects & Project Approach

The presentation should establish the applicant's record of successfully completing projects of similar scope and complexity. Experience with public educational or technical facilities should be indicated.

HVAC Replacements – Occupied Campus



Pierce Middle School – HVAC Replacement



Sickles High School Renovation

