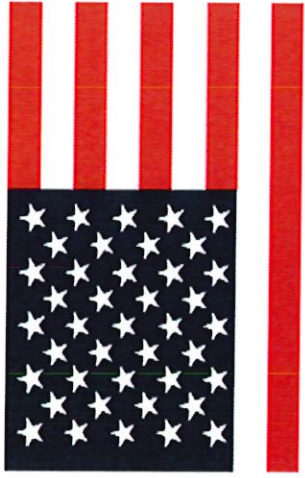

Exhibit "A"
Sign Graphic



CHAMBERS
LAW FIRM, P.A. —
BEACH VOLLEYBALL FACILITY
AT SPRINGSTEAD HIGH SCHOOL

THANK YOU TO OUR BUILDING PARTNERS

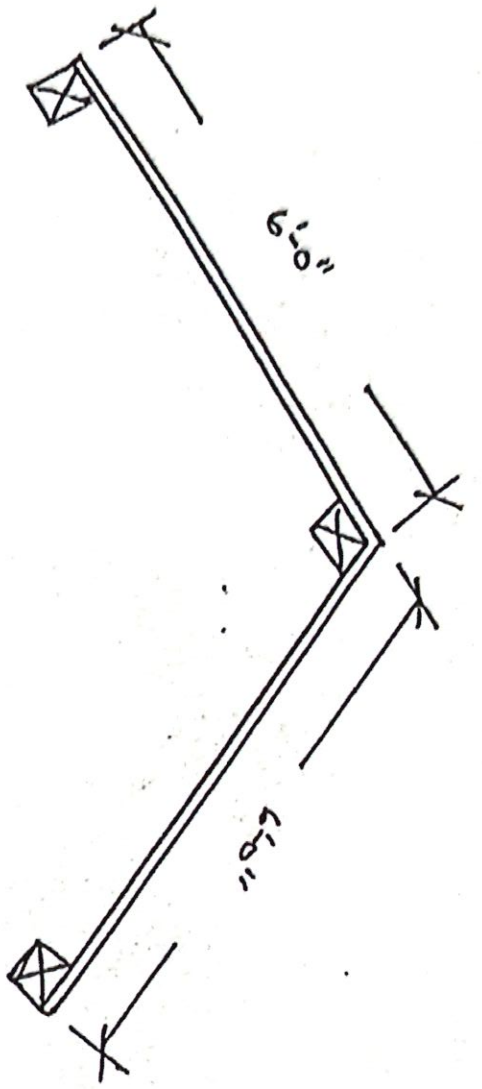

Exhibit "B"
Sign Location



Exhibit "C"
Sign Architectural Drawings

SPRINGFIELD HIGH SCHOOL BEACH VOLLEYBALL
 SCALE: 1:20



V-SIGNS LAYOUT

(6) 1 1/2" x 4" LAG SCREWS (PER SIGN PANEL)

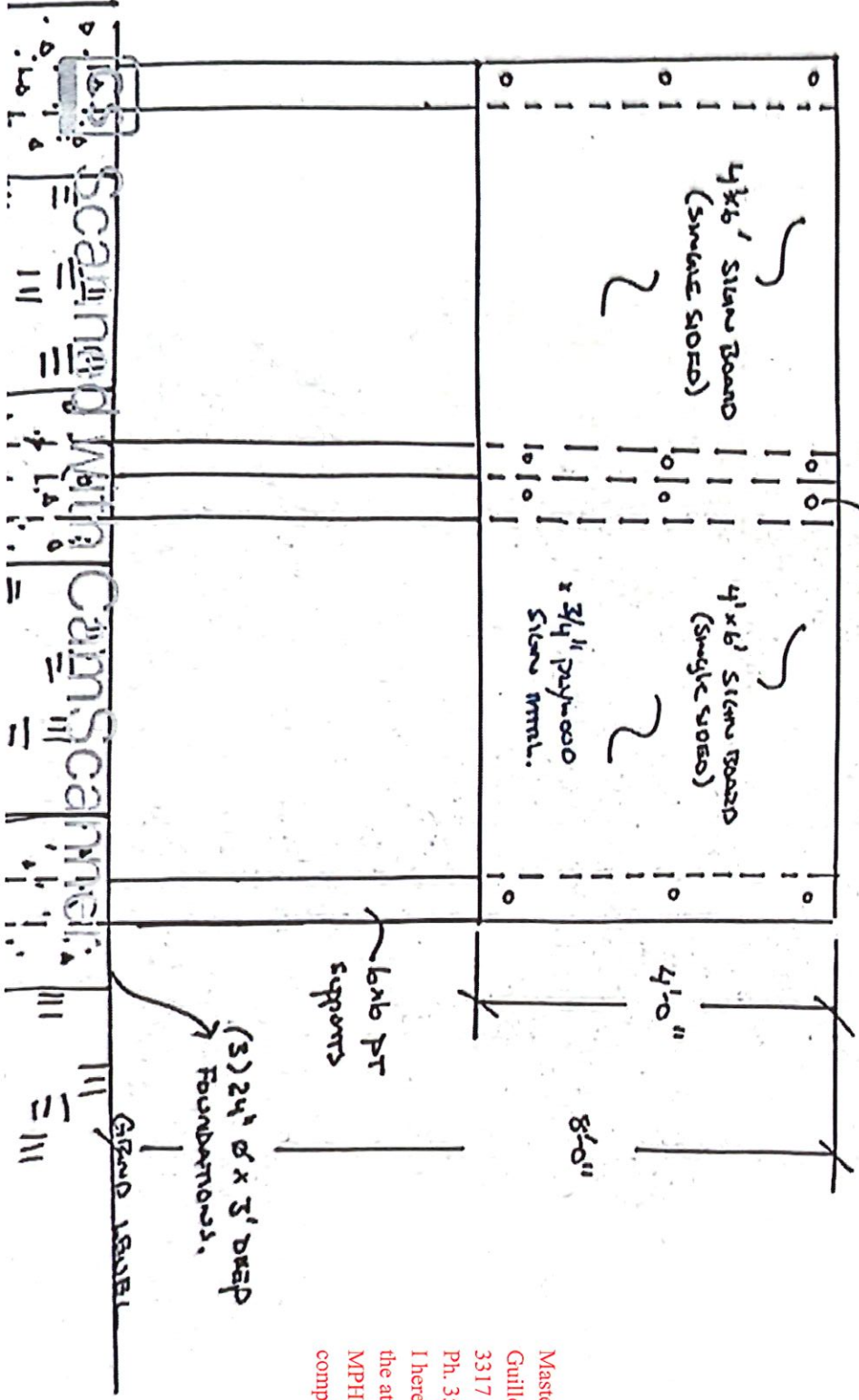

Master Engineering Corp. #9328
 Guillermo Castillo, PE #52591
 3317 Mariner Blvd., S.H. FL 34609
 Ph. 352 684 1807
 I hereby certify that I have performed the attached design to comply with 145 MPH 3 SEC gust loads and it is in compliance with the 2023 FBC

Exhibit "D"
Hernando County School District Contractor Insurance Requirements

CONSTRUCTION CONTRACTOR’S INSURANCE AND BOND REQUIREMENTS

A. GENERAL

- 1. The Contractor shall procure and maintain all insurance requirements and limits, as set forth below, at his or her own expense, until completion of the project or as specified herein. The Contractor shall continue to provide evidence of such coverage to Hernando County School Board on an annual basis during the aforementioned period including all of the terms of the insurance and indemnification requirements of this agreement. All below insurance policies shall include a provision preventing cancellation without thirty (30) days’ prior notice by certified mail. A completed Certificate of Insurance shall be filed with the Facilities & Construction Representative within ten (10) days after the date of the Notice of Award, said Certificate to specifically Owner the inclusion of the coverages and provisions set forth herein and shall Owner whether the coverage is “claims made” or “per occurrence”.

B. COMMERCIAL GENERAL LIABILITY INSURANCE (CGL)

- 1. This insurance must protect the Contractor from all claims for bodily injury, including death and all claims for destruction of or damage to property (other than the Work itself), arising out of or in connection with any operations under this Contract, whether such operations be by the Contractor or by any Subcontractor under him or anyone directly or indirectly employed by the Contractor or by a Subcontractor. All such insurance shall be written with limits and coverages as specified below and shall be written on an occurrence form.

a. General Aggregate	\$2,000,000
b. Products – Completed Operations Aggregate	\$2,000,000
c. Each Occurrence	\$1,000,000
d. Personal Injury	\$1,000,000

- 2. The following coverages shall be included in the CGL:
 - a. Per project general aggregate (CG 25 03 or similar)
 - b. Additional Insured status in favor of the Hernando County School Board and any other parties as outlined in The Contract and must include both ONGOING Operations AND COMPLETED Operations per CG 20 10 10/01 and CG 20 37 10/01 or equivalent as permitted by law.
 - c. The policy shall be endorsed to be primary and non-contributory with any insurance maintained by Additional Insureds.
 - d. A waiver of Subrogation in favor of all Additional Insured parties.
 - e. Personal Injury Liability
 - f. Contractual Liability coverage to support indemnification obligation per Article 53.1
 - g. Explosion, collapse and underground (xcu)

CONSTRUCTION CONTRACTOR'S INSURANCE AND BOND REQUIREMENTS

3. The following exclusionary endorsements are prohibited in the CGL policy:
 - a. Damage to Work performed by Subcontract/Vendor (CG 22-94 or similar)
 - b. Contractual Liability Coverage Exclusion modifying or deleting the definition of an "insured contract" from the unaltered SO CG 0001 1001 policy from (CG 24 26 or similar)
 - c. If applicable to the Work to be performed: Residential or multi-family
 - d. If applicable to the Work to be performed: Exterior insulation finish systems
 - e. If applicable to the Work to be performed: Subsidence or Earth Movement

 4. The Contractor shall maintain general liability coverage including Products and Completed Operations insurance, and the Additional Insured with primary and non-contributory coverage as specified in this Contract for three (3) years after completion of the project.
- C. AUTOMOBILE LIABILITY INSURANCE – Includes business auto liability covering liability arising out of any auto (including owned, hired and non-owned autos).
1. Combined Bodily Injury and Property Damage Liability
 - a. Combined Single Limit (each accident): \$1,000,000

 - b. Coverages: Specific waiver of subrogation
- D. WORKERS' COMPENSATION INSURANCE
1. The Contractor shall procure and maintain Workers' Compensation Insurance at his or her own expense during the life of this Contract, including occupational disease provisions for all employees per statutory requirements. Policy shall contain a waiver of subrogation in favor of the Hernando County School Board.

 2. The Contractor shall also require each Subcontractor to furnish Workers' Compensation Insurance, including occupational disease provisions for all of the latter's employees, and to the extent not furnished, the Contractor accepts full liability and responsibility for Subcontractor's employees.

 3. In cases where any class of employees engaged in hazardous work under this Contract at the site of the Project is not protected under the Workers' Compensation statute, the Contractor shall provide, and shall cause each Subcontractor to provide, adequate and suitable insurance for the protection of employees not otherwise protected.
- E. UMBRELLA LIABILITY INSURANCE – For construction projects exceeding \$10,000,000, provide the following coverage:

CONSTRUCTION CONTRACTOR'S INSURANCE AND BOND REQUIREMENTS

1. The Contractor shall maintain umbrella/excess liability insurance on an occurrence basis in excess of the underlying insurance described in Section B-D above. Coverage shall follow the terms of the underlying insurance, included the additional insured and waiver of subrogation provisions. The amounts of insurance required in Sections above may be satisfied by the Contractor purchasing coverage for the limits specified or by any combination of underlying and umbrella limits, so long as the total amount of insurance is not less than the limits specified in each section previously mentioned.

- a. Each occurrence \$5,000,000
- b. Aggregate \$5,000,000

F. BUILDER'S RISK INSURANCE – For any construction project, provide the following coverage:

1. Unless waived in writing by the Facilities & Construction Representative, the Contractor shall purchase and maintain, in a company or companies lawfully authorized to do business in the jurisdiction in which the Project is located, property insurance written on a builder's risk "all-risk" or equivalent policy form in the amount of the initial Contract Sum, plus value of subsequent Contract Modifications and cost of materials supplied or installed by others, comprising total value for the entire Project at the site on a replacement cost basis without optional deductibles. Such property insurance shall be maintained, unless otherwise agreed in writing by all persons and entities who are beneficiaries of such insurance, until final payment has been made and no person or entity other than the Owner has an insurable interest in the property, or the date of substantial completion specified on the fully signed and executed Certificate of Substantial Completion (AIA G704).

- a. This insurance shall include interests of the Owner, the Contractor, Subcontractors and Sub- subcontractors in the Project as named insureds.
- b. All associated deductibles shall be the responsibility of the Contractor. Such policy may have a deductible clause but not to exceed ten thousand dollars (\$10,000.00).
- c. Property insurance shall be on an "all risk" or equivalent policy form and shall include, without limitation, insurance against the perils of fire (with extended coverage) and physical loss or damage including, without duplication of coverage, theft, vandalism, malicious mischief, collapse, earthquake, flood, windstorm, false work, testing and startup, temporary buildings and debris removal including demolition occasioned by enforcement of any applicable legal requirements, and shall cover reasonable compensation for Architect's and Contractor's services and expenses required as a result of such insured loss.

2. Contractor shall maintain Builders Risk coverage including partial use by Owner.

CONSTRUCTION CONTRACTOR'S INSURANCE AND BOND REQUIREMENTS

3. The Contractor shall waive all rights of subrogation as regards the Hernando County School Board and the Owner, its officials, its officers, its agents and its employees, all while acting within the scope and course of their employment For damages caused by fire or other causes of loss to the extent covered by property insurance obtained pursuant to this Section or other property insurance applicable to the Work. The Contractor shall require all Subcontractors at any tier to similarly waive all such rights of subrogation and shall expressly include such a waiver in all subcontracts.
4. Upon request, the amount of such insurance shall be increased to include the cost of any additional work to be done on the Project, or materials or equipment to be incorporated in the Project, under other independent contracts let or to be let. In such event, the Contractor shall be reimbursed for this cost as his or her share of the insurance in the same ratio as the ratio of the insurance represented by such independent contracts let or to be let to the total insurance carried.
5. The Owner, shall have the power to adjust and settle any loss. Unless it is agreed otherwise, all monies received shall be applied first on rebuilding or repairing the destroyed or injured work.

G. POLLUTION LIABILITY INSURANCE

1. If Contractor is providing directly or indirectly work with pollution/environmental hazards, the Contractor must provide or cause those conducting the work to provide Pollution Liability Insurance coverage.
 - a. Pollution Liability policy must include contractual liability coverage.
 - b. Hernando County School Board must be included as additional insureds on the policy.
 - c. The policy limits shall be in the amount of \$1,000,000 with maximum deductible of \$25,000 to be paid by the Subcontractor/Vendor.

H. ADDITIONAL MISCELLANEOUS INSURANCE PROVISIONS – Certificates of Insurance and/or insurance policies required under this Contract shall be subject to the following stipulations and additional requirements:

1. Any and all deductibles or self-insured retentions contained in any Insurance policy shall be assumed by and at the sole risk of the Contractor;
2. If any of the said policies shall fail at any time to meet the requirements of the Contract Documents as to form or substance, or if a company issuing any such policy shall be or at any time cease to be approved by the Division of Insurance of the Hernando County School Board, or be or cease to be in compliance with any stricter requirements of the Contract Documents, the Contractor shall promptly obtain a new policy, submit the same to the Owner and Owner Building Programs for approval if requested, and submit a

CONSTRUCTION CONTRACTOR'S INSURANCE AND BOND REQUIREMENTS

Certificate of Insurance as hereinbefore provided. Upon failure of the Contractor to furnish, deliver and maintain such insurance as provided herein, this Contract, in the sole discretion of the Hernando County School Board, may be immediately declared suspended, discontinued, or terminated. Failure of the Contractor in obtaining and/or maintaining any required insurance shall not relieve the Contractor from any liability under the Contract, nor shall the insurance requirements be construed to conflict with the obligations of the Contractor concerning indemnification;

3. All requisite insurance shall be obtained from financially responsible insurance companies, authorized to do business in the State of Florida and acceptable to the Owner;
4. Receipt, review or acceptance by the Facilities & Construction Representative of any insurance policies or certificates of insurance required by this Contract shall neither be construed as a waiver nor relieve the Contractor from its obligation to meet the insurance requirements contained herein.

I. PAYMENT AND PERFORMANCE BOND

1. The Contractor shall procure surety bonds, from a company or companies lawfully authorized to issue surety bonds in the state of Florida and listed in the Federal Register of the U.S. Department of Treasury for Surety Companies Acceptable on Federal Bonds, as follows:
 - a. Before commencing the Work on any individual project having a Contract Sum of \$200,000 or more, the Contractor shall execute and record in the public records of Hernando County, Florida, a payment and performance bond. The bond must state on its front page:
 - i. The names, principal business addresses, and phone numbers of the Contractor, the surety, and the Owner
 - ii. The project number assigned by the Owner
 - iii. The bond number assigned by the surety
 - iv. A description of the project sufficient to identify it, such as a legal description or the street address of the property being improved, and a general description of the improvement
 - b. The amount of the bond shall equal the full amount of the Contract Sum.
 - c. The bond shall be conditioned upon the contractor's performance of the Work in the time and manner prescribed in the contract and promptly making payments to all persons who furnish labor, services, or materials for the Work provided for in the contract.

CONSTRUCTION CONTRACTOR'S INSURANCE AND BOND REQUIREMENTS

- d. A copy of the recorded bond shall be filed with the Facilities & Construction Representative prior to issuance of any payment.

- e. If, prior to completion of the Work, the Contractor receives a notice that the company or companies that issued the bond has lost or had revoked its license or authority to do business in Florida as a surety insurer, the Contractor shall, within ten (10) calendar days following receipt of such notice, execute and record in the public records a replacement payment and performance bond from a duly authorized surety. The amount of the replacement bond shall equal the full amount of the Contract Sum less the value of the Work in place and accepted at the time such bond is issued.